

WINDSHIELD MOUNTS
INSTALLATION INSTRUCTIONS
STR-5KS03-40-01
"V-STAR CLASSIC"



INTRODUCTION

Please read and understand these instructions completely before installation to avoid any possible injury to yourself or damage to your motorcycle and/or accessory.

DEALER: These instructions contain important information for future reference and must be given to the customer.

PARTS LIST

Item	Part Name	Description	Qty
①	Windshield Mount, Left		1
②	Windshield Mount, Left RIGHT		1
③	Rod Assembly, Windshield Mount		1
④	Bolt, Button Head	M8-1.25P x 45	2
⑤	Bolt, Hex Socket Head	M8-1.25P x 55	2
⑥	Washer	M8	4
⑦	Bolt, Flange Head	M8-1.25P x 20	4
⑧	Bolt, Button Head	M8-1.25P x 15	2
⑨	Windshield Assembly	Order separately	Ref.

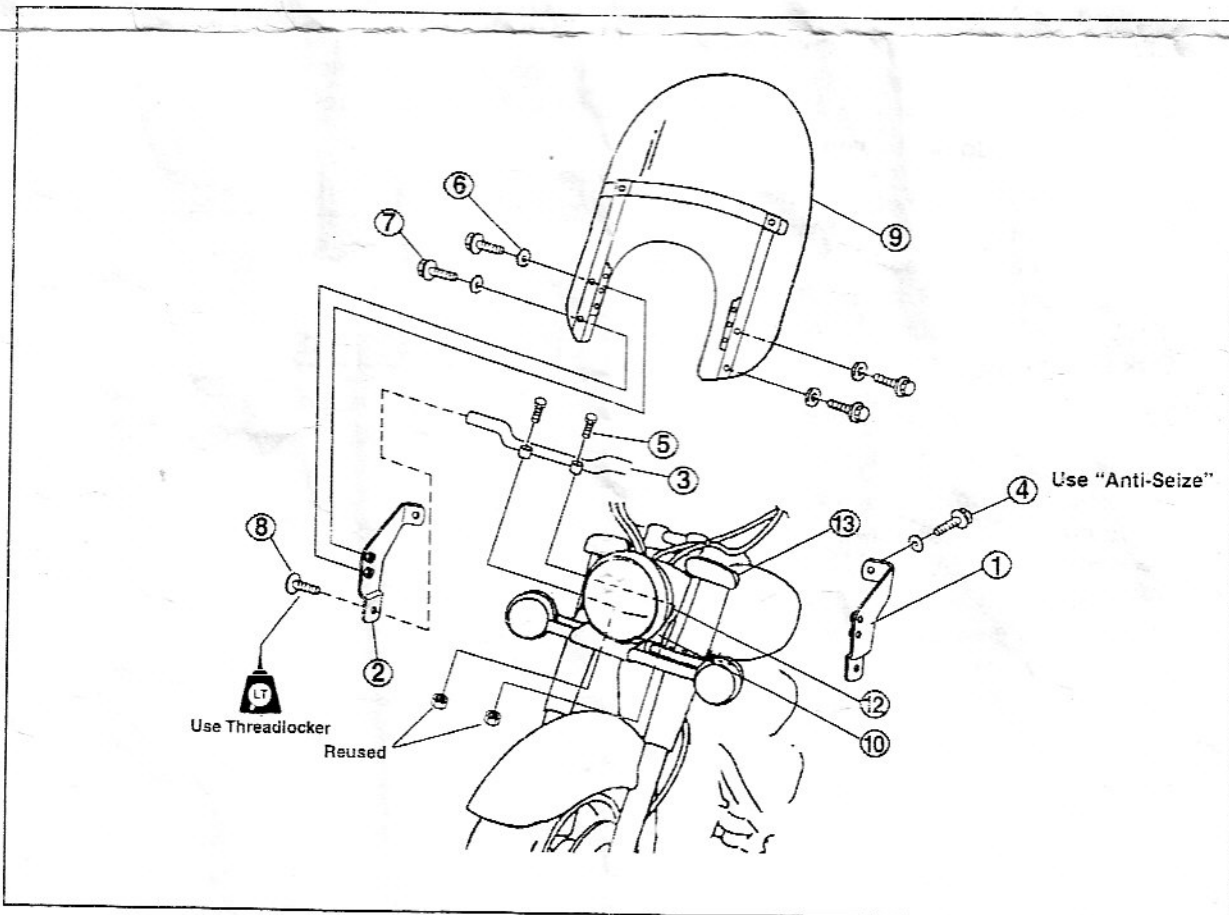

PREPARATION

CAUTION:

Cover the Fuel Tank and Fender to protect from damage.

1. Place the motorcycle securely on its side stand.
2. Remove the Headlight Assembly mounting bolts. The nuts will be reused, store the bolts.
3. Remove and store the fork pinch bolts from the upper Fork Clamp.

INSTALLATION

Mount the Windshield Stay Assembly

1. Lean the Headlight Assembly forward. Position the Rod Assembly ③ so its ends are forward of the mounting bushings, then align the bushings with the holes in the headlight bucket.
2. Insert the Mounting Bolts ⑤, first through the Rod Assembly ③, bushings, then the Headlight Assembly bucket mounting holes, and finally the mounting-bolt holes in the lower fork clamp. Start the Nuts onto the Screws ⑤, but do not tighten yet.
3. Position the left-side Windshield Mount ①, so its mounting bushing is inserted into the recess for the pinch bolt in the upper Fork Clamp. Insert an M8 x 45 Bolt ④ through the Windshield Mount ① into the upper Fork Clamp. Do not tighten the screw yet.

NOTE: Use "Anti-Seize" on M8 x 45 Bolts.

4. Check that the lower holes of the Windshield Mount ①, align with the end of the Rod Assembly ③. Apply threadlocker to the threads of an M8 x 16 Bolt ⑧, and then insert the Bolt through the Windshield Mount into the end of the Rod. Do not tighten the screw yet.

NOTE: Use Loctite® 242 on the threads.

5. Repeat steps 3 and 4 on the right side, using the Windshield Mount ②.
6. When all parts are installed, tighten the hardware to **17 ft-lb (23 Nm, 2.3 m-kg)** in the following order:
 - a. Lower Rod Assembly to lower Fork Clamp
 - b. Windshield Mount to upper Fork Clamp
 - c. Windshield Mount to Rod Assembly

WINDSHIELD MOUNTING

1. Choose either the high or low mounting position. Position the Windshield Assembly ⑨, so its vertical brackets are on the outside of the Windshield Mounts. Attach the Windshield using the M8 x 20 Bolts ⑦, and Washers ⑥.
2. Tighten the Bolts to **17 ft-lb (23 N, 2.3 m-kg)**.

MAINTENANCE

Periodically check mounting hardware for tightness. Re-torque if necessary.

CARE AND CLEANING

Refer to your **Owner's Manual**.

CUSTOMER SERVICE

For more information regarding installation, please contact your Yamaha dealer.